

Priključci za crevne instalacije / Hose fittings

*Priključci za niski pritisak i povratne vodove (gorivo, vazduh , ulje)

*Priključci i caure za visoki pritisak (metricki, BSPP, BSPT, NPT,UNF,ORFS, SAE3000,SAE6000....)

*Low pressure fittings (diesel fuel, air, oil)

*High pressure fittings and ferules (metric, BSPP, BSPT, NPT, UNF,ORFS, SAE3000,SAE6000...)

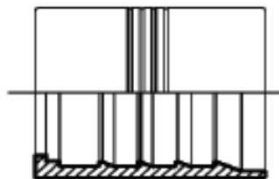
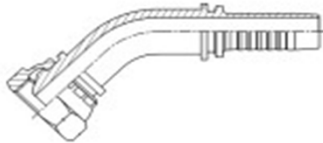
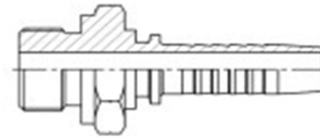
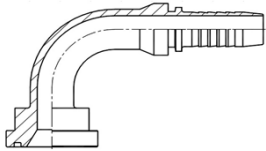

Priklučci za niski pritisak / Low pressure fittings

Čaura / Ferulle

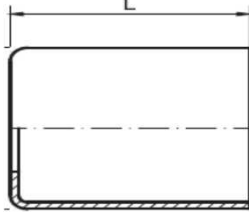

NP / DN	naziv/name	O.D (mm)	I.D (mm)
4	13/11	13.00	11.00
6	14/12	14.00	12.00
8	15/13	15.00	13.00
10	18/16	18.00	14.00
13	23/21	23.00	21.00

Čaura za Gč,M,Mt,K crevo (DIN 73379/79 + Zica,SAE 100 R6, DIN 74310) , aluminijum
 Ferulle for low pressure hose (DIN 73379/79 + Wire,SAE 100 R6,DIN 74310) aluminum

Priklučak A / Stright female fitting type "A"

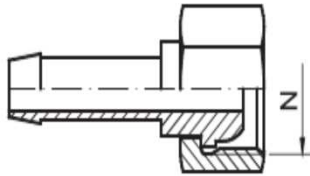

NP / DN	naziv/name	Navoj-thread	ok
4	A Gč4 M10x1	M10x1	14
4	A Gč4	M12x1,5	14
6	A Gč6	M14X1,5	17
8	A Gč8	M16x1,5	19
10	A Gč10	M18x1,5	22
13	A Gč13	M22x1,5	27

Priklučak tipa "A" za zaptivno sedište 24°,za crevo DIN 73379/79 + Zica,SAE 100 R6, DIN 74310 , Gc, K,M.
 Low pressure hose fitting "A" 24°,(for hoses DIN 73379/79 + Wire,SAE 100 R6,DIN 74310)

Priklučak D / Stright male fitting type "D"

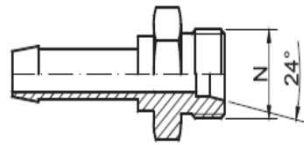

NP / DN	naziv/name	Navoj-thread	ok
4	D Gč4 M10x1	M10x1	12/14
4	D Gč4	M12x1,5	14
6	D Gč6	M14X1,5	17
8	D Gč8	M16x1,5	19
10	D Gč10	M18x1,5	22
13	D Gč13	M22x1,5	24/27

Priklučak tipa "D" za zaptivno sedište 24°,za crevo DIN 73379/79 + Zica,SAE 100 R6, DIN 74310 , Gc, K,M.
 Low pressure hose fitting "D" 24°,(for hoses DIN 73379/79 + Wire,SAE 100 R6,DIN 74310)

Priklučak J / Banjo fitting type "J"

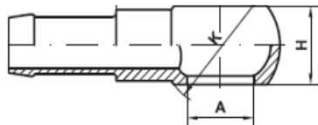

NP / DN	naziv/name	A(mm)	K
4	J Gč4 Ø8	8.00	Ø14
4	J Gč4 Ø10	10.00	Ø18
4	J Gč4 Ø14	14.00	Ø24
6	J Gč6 Ø12	12.00	Ø20
6	J Gč6 Ø14	14.00	Ø24
8	J Gč8 Ø14	14.00	Ø24
8	J Gč8 Ø12	12.00	Ø20
10	J Gč10 Ø16	16.00	Ø28
10	J Gč10 Ø18	18.00	Ø32
12	J Gč12 Ø18	18.00	Ø32
12	J Gč12 Ø22	22.00	Ø38

Priklučak tipa "J" okasti priključak,za crevo DIN 73379/79 + Zica,SAE 100 R6, DIN 74310 , Gc, K,M.
 Low pressure hose fitting "J" EYE -Banjo fitting,(for hoses DIN 73379/79 + Wire,SAE 100 R6,DIN 74310)

Čaura za visoki pritisak - Ferrules for high pressure hoses

1SN 853 Blankovanje-Skive ferrule 1SN 853

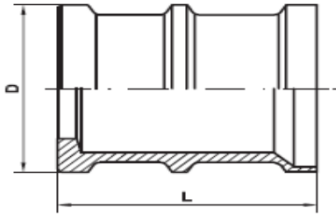

NP/DN	naziv/name	D	L
4	V1np4	16	26,00
6	V1np6	18	29,00
8	V1np8	20	29,00
10	V1np10	22	30,00
12	V1np12	25	31

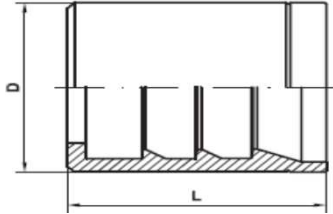

NP/DN	naziv/name	D	L
16	V1np16	30	38,00
19	V1np19	32	38,00

2SN 853 Blankovanje-Skive ferrule 2SN 853

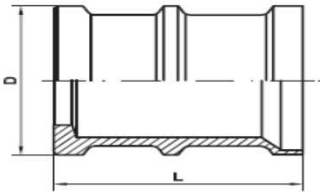

NP/DN	naziv/name	D	L
4	V2 np4	18	26,00
6	V2 np6	20	29,00
8	V2 np8	22	29,00
10	V2 np10	24	30,00

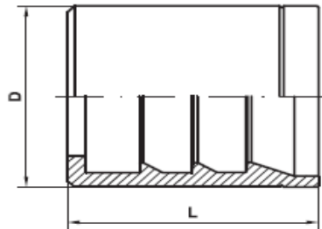

NP/DN	naziv/name	D	L
12	V2 np12	28	35,00
16	V2 np16	32	37,00
19	V2 np19	36	49,00
25	V2 np25	45	53,00
32	V2 np32	55	53,00

1SN,2SN 853 Bez blankovanja- NO-Skive ferrule 1SN, 2SN 853

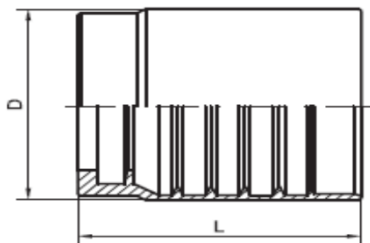

NP/DN	naziv/name	D	L
4	NS np 4	21	23
6	NS np 6	23	30
8	NS np 8	24	30
10	NS np 10	26	32
12	NS np 12	29	34
16	NS np 16	33	37
19	NS np 19	37	42
25	NS np 25	46	51
32	NS np 32	59	59
38	NS np 38	67	67
50	NS np 50	80	72

Čaura za visoki pritisak - Ferrules for high pressure hoses

Čaura za termoplastično crevo P7R- Thermoplastic hose ferrule P7R

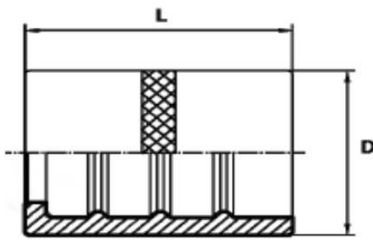

NP/DN	naziv/name	D	L
4	Tp4	16	30,00
6	Tp6	18	30,00
8	Tp8	20	30,00
10	Tp10	22	30,00
12	Tp12	25	34,00
16	Tp16	30	36,00
19	Tp19	32	42,00
25	Tp25	40	50,00

4SP856

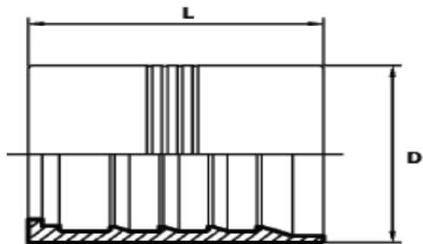

NP/DN	naziv/name	D	L
6	4sp np6	22	30,00
10	4sp np10	26	32,00
12	4sp np12	30	34,00
16	4sp np16	34	40,00
19	4sp np19	38	45,00
25	4sp np25	46	60,00
32	4sp np32	56	66,00
38	4sp np38	65	76,00
50	4sp np50	80	80,00

4SH856

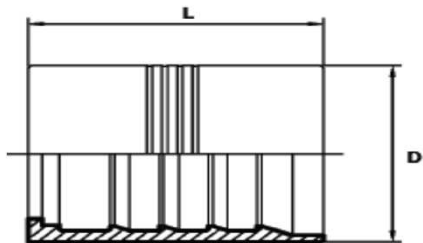

NP/DN	naziv/name	D	L
20	4sh np20	38	60,00
25	4sh np25	46	74,00
32	4sh np32	56	88,00
38	4sh np38	62	94,00

Čaura za teflonsko crevo - Teflon hose ferrule

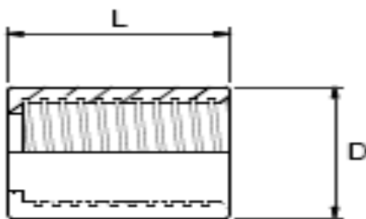

NP/DN	naziv/name	D	L
6	Tp6	14	21
8	Tp8	16	22
10	Tp10	18	24
12	Tp12	22	24
16	Tp16	26	24
19	Tp19	30	25
25	Tp25	36	27

Priključci za visoki pritisak 1sn,2sn,4sp / High pressure hose fittings 1sn,2sn,4sp

Priključak A (DKL,DKOL 24°) / Female fitting type"A" (DKL, DKOL)

Prav A / Straight A



Krivina 45° A1 / Elbow 45° A1



Krivina 90° A2 / Elbow 90° A2

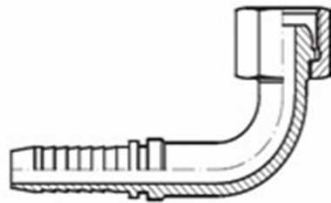

NP/DN	prav/straight	45°	90°	navoj/thread
4	Anp4 6L	A1np4 6L	A2np4 6L	M12x1,5 6L
6	Anp6 8L	A1np6 8L	A2np6 8L	M14x1,5 8L
6	Anp6 M12x1,5 6L	A1np6 M12x1,5 6L	A2np6 M12x1,5 6L	M12x1,5 6l
6	Anp6 M16x1,5 10L	A1np6 M16x1,5 10L	A2np6 M16x1,5 10L	M16x1,5 10L
8	Anp8 10L	A1np8 10L	A2np8 10L	M16x1,5 10L
8	Anp8 M14x1,5 8L	A1np8 M14x1,5 8L	A2np8 M14x1,5 8L	M14x1,5 8L
8	Anp8 M18x1,5 12L	A1np8 M18x1,5 12L	A2np8 M18x1,5 12L	M18x1,5 12L
10	Anp10 12L	A1np10 12L	A2np10 12L	M18x1,5 12L
10	Anp10 M16x1,5 10L	A1np10 M16x1,5 10L	A2np10 M16x1,5 10L	M16x1,5 10L
10	Anp10 M20x1,5 12L	A1np10 M20x1,5 12L	A2np10 M20x1,5 12L	M20x1,5 12L
10	Anp10 M22x1,5 15L	A1np10 M22x1,5 15L	A2np10 M22x1,5 15L	M22x1,5 15L
12	Anp12 15L	A1np12 15L	A2np12 15L	M22x1,5 15L
12	Anp12 M18x1,5 12L	A1np12 M18x1,5 12L	A2np12 M18x1,5 12L	M18x1,5 12L
12	Anp12 M26x1,5 18L	A1np12 M26x1,5 18L	A2np12 M26x1,5 18L	M26x1,5 18L
16	Anp16 18L	A1np16 18L	A2np16 18L	M26x1,5 18L
16	Anp16 M30x2 22L	A1np16 M30x2 22L	A2np16 M30x2 22L	M30x2 22L
19	Anp19 22L	A1np19 22L	A2np19 22L	M30x2 22L
19	Anp19 M30x1,5 22L	A1np19 M30x1,5 22L	A2np19 M30x1,5 22L	M30x1,5
19	Anp19 M36x2 28L	A1np19 M36x2 28L	A2np19 M36x2 28L	M36x2 28L
25	Anp25 28L	A1np25 28L	A2np25 28L	M36x2 28L
25	Anp25M38x1,5 28L	A1np25M38x1,5 28L	A2np25M38x1,5 28L	M38x1,5
25	Anp25M45x2 35L	A1np25M45x2 35L	A2np25M45x2 35L	M45x2 35L
32	Anp32 35L	A1np32 35L	A2np32 35L	M45x2 35L
32	Anp32M45x1,5 35L	A1np32M45x1,5 35L	A2np32M45x1,5 35L	M45x1,5

Priključak tipa A za zaptivno sedište 24°, laki red, odgovara standardu DKL odnosno DKOL (zaptivanje na O-prsten)

Hose fitting type A, Light series 24° according DKL,DKOL

Priključak D (CEL, 24°) / Male fitting type"D" (CEL)



NP/DN	prav/straight	navoj/thread
4	Dnp4	M12x1,5 6L
6	Dnp6	M14x1,5 8L
8	Dnp8	M16x1,5 10L
10	Dnp10	M18x1,5 12L
12	Dnp12	M22x1,5 15L
16	Dnp16	M26x1,5 18L
19	Dnp19	M30x2 22L
25	Dnp25	M36x2 28L
32	Dnp32	M45x2 35L

Priključak tipa D za zaptivno sedište 24°, laki red, odgovara standardu CEL 24°

Hose fitting type D, Light series 24° according CEL

Priključci za visoki pritisak 1sn,2sn,4sp / High pressure hose fittings 1sn,2sn,4sp

Priključak B (DKS,DKOS 24°) / Female fitting type"B" (DKS, DKOS)

Prav B / Straight B



Krivina 45° B1 / Elbow 45° B1



Krivina 90° B2 / Elbow 90° B2

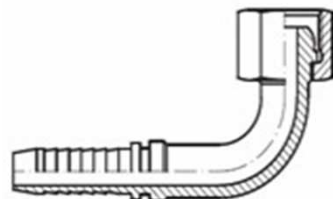

NP/DN	prav/straight	45°	naziv/name	navoj/thread
4	Bnp4 8S	B1np4 8S	B2np4 8S	M16x1,5 8S
6	Bnp6 10S	B1np6 10S	B2np6 10S	M18x1,5 10S
6	Bnp6 M16x1,5 8S	B1np6 M16x1,5 8S	B2np6 M16x1,5 8S	M16x1,5 8S
6	Bnp6 M20x1,5 12S	B1np6 M20x1,5 12S	B2np6 M20x1,5 12S	M20x1,5 12S
8	Bnp8 12S	B1np8 12S	B2np8 12S	M20x1,5 12S
8	Bnp8 M18x1,5 10S	B1np8 M18x1,5 10S	B2np8 M18x1,5 10S	M18x1,5 10S
8	Bnp8 M22x1,5 14S	B1np8 M22x1,5 14S	B2np8 M22x1,5 14S	M22x1,5 14S
10	Bnp10 14S	B1np10 14S	B2np10 14S	M22x1,5 14S
10	Bnp10 M20x1,5 12S	B1np10 M20x1,5 12S	B2np10 M20x1,5 12S	M20x1,5 12S
10	Bnp10 M24x1,5 16S	B1np10 M24x1,5 16S	B2np10 M24x1,5 16S	M24x1,5 16S
12	Bnp12 16S	B1np12 16S	B2np12 16S	M24x1,5 16S
12	Bnp12 M22x1,5 14S	B1np12 M22x1,5 14S	B2np12 M22x1,5 14S	M22x1,5 14S
12	Bnp12 M30x2 20S	B1np12 M30x2 20S	B2np12 M30x2 20S	M30x2 20S
16	Bnp16 20S	B1np16 20S	B2np16 20S	M30x2 20S
16	Bnp16 M24x1,5 16S	B1np16 M24x1,5 16S	B2np16 M24x1,5 16S	M24x1,5 16S
16	Bnp16 M36X2 25S	B1np16 M36X2 25S	B2np16 M36X2 25S	M36X2 25S
19	Bnp19 25S	B1np19 25S	B2np19 25S	M36X2 25S
19	Bnp19 M30x2 20S	B1np19 M30x2 20S	B2np19 M30x2 20S	M30x2 20S
19	Bnp19 M42x2 30S	B1np19 M42x2 30S	B2np19 M42x2 30S	M42x2 30S
25	Bnp25 30S	B1np25 30S	B2np25 30S	M42x2 30S
25	Bnp25M52x2 38S	B1np25M52x2 38S	B2np25M52x2 38S	M52x2 38S
32	Bnp32 38S	B1np32 38S	B2np32 38S	M52x2 38S

Priključak tipa B za zaptivno sedište 24°, teški red, odgovara standardu DKS odnosno DKOS (zaptivanje na O-prsten)
Hose fitting type B, Heavy series 24° according DKS,DKOS

Priključak E (CES, 24°) / Male fitting type"B" (CES)



NP/DN	prav/straight	navoj/thread
4	E np4	M16x1,5 8S
6	E np6	M18x1,5 10S
8	E np8	M20x1,5 12S
10	E np10	M22x1,5 14S
12	E np12	M24x1,5 16S
16	E np16	M30x2 20S
19	E np19	M36X2 25S
25	E np25	M42x2 30S
25	E np32	M52x2 38S

Priključak tipa E za zaptivno sedište 24°, teški red, odgovara standardu DKS odnosno DKOS (zaptivanje na O-prsten)
Hose fitting type E, Heavy series 24° according DKS,DKOS

Priklučci za visoki pritisak 1sn,2sn,4sp / High pressure hose fittings 1sn,2sn,4sp

Priklučak A5 (DKR, 60°) / Female BSPP fitting 60° cone (DKR)

Prav A5 / Straight A5



Krivina 45° A6 / Elbow 45° A6

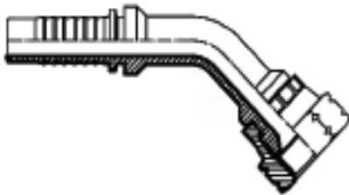

Krivina 90° A7 / Elbow 90° A7

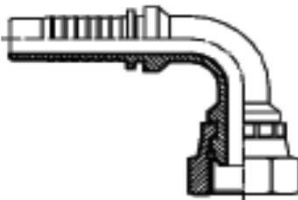

NP/DN	prav/straight	45°	90°	navoj/thread
6	A5np6 G1/8"	A6np6 G1/8"	A7np6 G1/8"	G 1/8"
6	A5np6	A6np6	A7np6	G 1/4"
6	A5np6 G3/8"	A6np6 G3/8"	A7np6 G3/8"	G 3/8"
8	A5np8	A6np8	A7np8	G 3/8"
8	A5np8 G1/4"	A6np8 G1/4"	A7np8 G1/4"	G 1/4"
8	A5np8 G1/2"	A6np8 G1/2"	A7np8 G1/2"	G 1/2"
10	A5np10	A6np10	A7np10	G 3/8"
10	A5np10 G1/2"	A6np10 G1/2"	A7np10 G1/2"	G 1/2"
12	A5np12	A6np12	A7np12	G 1/2"
12	A5np12 G3/8"	A6np12 G3/8"	A7np12 G3/8"	G 3/8"
12	A5np12 G5/8"	A6np12 G5/8"	A7np12 G5/8"	G 5/8"
16	A5np16	A6np16	A7np16	G 5/8"
16	A5np16 G3/4"	A6np16 G3/4"	A7np16 G3/4"	G 3/4"
16	A5np16 G1"	A6np16 G1"	A7np16 G1"	G 1"
19	A5np19	A6np19	A7np19	G 3/4"
19	A5np19 G1"	A6np19 G1"	A7np19 G1"	G 1"
25	A5np25	A6np25	A7np25	G 1"
25	A5np25 G1.1/4"	A6np25 G1.1/4"	A7np25 G1.1/4"	G1.1/4"
32	A5np32	A6np32	A7np32	G1.1/4"
32	A5np32 G1.1/2"	A6np32 G1.1/2"	A7np32 G1.1/2"	G1.1/2"
38	A5np38	A6np38	A7np38	G1.1/2"

Priklučak tipa A5 za zaptivno sedište 60° , BSPP , odgovara standardu DKR
Hose fitting type A5, Female BSPP 60°cone according DKR

Priklučak F5 (AGR, 60°) / Male BSPP fitting 60° cone (AGR)

Prav F5 / Straight F5



NP/DN	prav/straight	navoj/thread
4	F5np4	G 1/8"
6	F5np6	G 1/4"
8	F5np8	G 3/8"
10	F5np10	G 3/8"
12	F5np12	G 1/2"
16	F5np16	G 5/8"
19	F5np19	G 3/4"
25	F5np25	G 1"
32	F5np32	G1.1/4"
38	F5np38	G1.1/2"

Priklučak tipa F5 za zaptivno sedište 60° , BSPP , odgovara standardu AGR
Hose fitting type F5, Male BSPP 60°cone according AGR

Priključci za visoki pritisak 1sn,2sn,4sp / High pressure hose fittings 1sn,2sn,4sp

Priključak Q (DKJ,74° UNF) / Female JIC fitting 74° cone (DKJ, 74° UNF)

Prav Q / Straight Q



Krivina 45° Q1 / Elbow 45° Q1

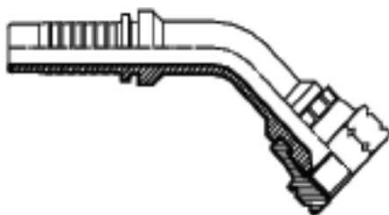

Krivina 90° Q2 / Elbow 90° Q2

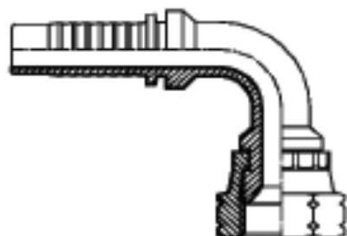

NP/DN	naziv/name	45°	90°	navoj/thread
4	Qnp4 7/16	Q1np4 7/16	Q2np4 7/16	7/16"- unf
4	Qnp4 1/2	Q1np4 1/2	Q2np4 1/2	1/2"- unf
6	Qnp6	Q1np6	Q2np6	7/16"- unf
6	Qnp6 1/2	Q1np6 1/2	Q2np6 1/2	1/2"- unf
6	Qnp6 9/16	Q1np6 9/16	Q2np6 9/16	9/16"- unf
8	Qnp8	Q1np8	Q2np8	1/2"- unf
8	Qnp8 9/16	Q1np8 9/16	Q2np8 9/16	9/16"- unf
8	Qnp8 5/8	Q1np8 5/8	Q2np8 5/8	5/8"- unf
10	Qnp10	Q1np10	Q2np10	9/16"- unf
10	Qnp10 5/8	Q1np10 5/8	Q2np10 5/8	5/8"- unf
10	Qnp10 3/4	Q1np10 3/4	Q2np10 3/4	3/4"- unf
10	Qnp10 7/8	Q1np10 7/8	Q2np10 7/8	7/8"- unf
12	Qnp12	Q1np12	Q2np12	3/4"- unf
12	Qnp12 7/8	Q1np12 7/8	Q2np12 7/8	7/8"- unf
12	Qnp12 1.1/16	Q1np12 1.1/16	Q2np12 1.1/16	1.1/16"- unf
16	Qnp16	Q1np16	Q2np16	7/8"- unf
16	Qnp16 1.1/16	Q1np16 1.1/16	Q2np16 1.1/16	1.1/16"- unf
19	Qnp19	Q1np19	Q2np19	1.1/16"- unf
19	Qnp19 7/8	Q1np19 7/8	Q2np19 7/8	7/8"- unf
19	Qnp19 1.3/16	Q1np19 1.3/16	Q2np19 1.3/16	1.3/16"- unf
19	Qnp19 1.5/16	Q1np19 1.5/16	Q2np19 1.5/16	1.5/16"- unf
25	Qnp25	Q1np25	Q2np25	1.5/16"- unf
25	Qnp25 1.1/16	Q1np25 1.1/16	Q2np25 1.1/16	1.1/16"- unf
25	Qnp25 1.5/8	Q1np25 1.5/8	Q2np25 1.5/8	1.5/8"- unf
32	Qnp32	Q1np32	Q2np32	1.5/8"- unf
32	Qnp32 1.7/8	Q1np32 1.7/8	Q2np32 1.7/8	1.7/8"-unf
38	Qnp38	Q1np38	Q2np38	1.7/8"-unf
50	Qnp38	Q1np38	Q2np38	2.1/2"-unf

Priključak tipa Q za zaptivno sedište 74° , UNF americki colovni navoj , odgovara standardu DKJ

Hose female fitting type Q, UNF 74° according DKJ

Priključak N (AGJ, 74° , UNF) / Male JIC fitting 74° cone (AGJ, 74° , UNF)

Prav N / Straight N



Muški priključak tipa N
za zaptivno sediste 74°, JIC , UNF navoj
Male fitting type N ,
74° cone JIC, UNF thread

NP/DN	prav/straight	navoj/thread
4	N np4	7/16"- unf
6	N np6	7/16"- unf
6	N np6 1/2"	1/2"- unf
8	N np8	1/2"- unf
8	N np8 9/16"	9/16"- unf
10	N np10	9/16"- unf
10	N np10 3/4"	3/4"- unf
12	N np12	3/4"- unf
12	N np12 7/8"	7/8"- unf
16	N np16	7/8"- unf
19	N np19	1.1/16"- unf
19	N np19 1.3/16"	1.3/16"- unf
25	N np25	1.5/16"- unf
32	N np32	1.5/8"- unf
38	N np38	1.7/8"-unf

Priklučci za visoki pritisak 1sn,2sn,4sp / High pressure hose fittings 1sn,2sn,4sp

Priključak Q5 (DKJ,74° Milimetarski navoj) / Female fitting 74° cone METRIC thread (DKJ, 74° Metric)

Prav Q5 / Straight Q5



NP/DN	naziv/name	45°	90°	navoj/thread
4	Q5np4	Q6np4	Q7np4	M12x1,5
6	Q5np6	Q6np6	Q7np6	M14x1,5
8	Q5np8	Q6np8	Q7np8	M16x1,5
10	Q5np10	Q6np10	Q7np10	M18x1,5
12	Q5np12	Q6np12	Q7np12	M22x1,5
16	Q5np16	Q6np16	Q7np16	M27x2
19	Q5np19	Q6np19	Q7np19	M33x2
25	Q5np25	Q6np25	Q7np25	M39x2

Krivina 45° Q6 / Elbow 45° Q6

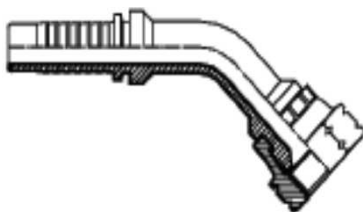

Krivina 90° Q7 / Elbow 90° Q7

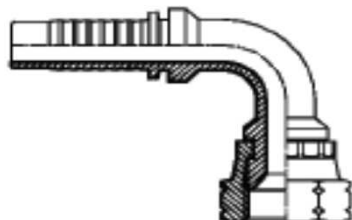

Priključak tipa Q5 za zaptivno sedište 74° ,milimetarski navoj , odgovara standardu DKJ METRIC

Hose female fitting type Q5, 74° METRIC thread according DKJ 74° Metric

Priključak N5 (AGJ, 74° METRIC) / Male fitting 74° cone METRIC thread (AGJ, 74° Metric)

Prav N5 / Straight N5



NP/DN	prav/straight	navoj/thread	
4	N5np4	M12x1,5	
6	N5np6	M14x1,5	
8	N5np8	M16x1,5	
10	N5np10	M18x1,5	
12	N5np12	M22x1,5	
16	N5np16	M27x2	
19	N5np19	M33x2	
25	N5np25	M39x2	

Muški priključak tipa N5 za zaptivno sedište 74° ,milimetarski navoj , odgovara standardu AGJ 74° METRIC

Hose male fitting type N5, 74° METRIC thread according DKJ 74° Metric

Priklučci za visoki pritisak 1sn,2sn,4sp / High pressure hose fittings 1sn,2sn,4sp

Priklučak O (ORFS),ravno zaptivanje / Female flat face ORFS fitting

Prav O / Straight O

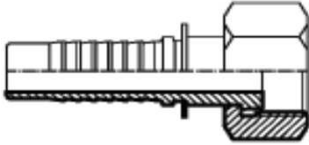

Krivina 45° O1 / Elbow 45° O1

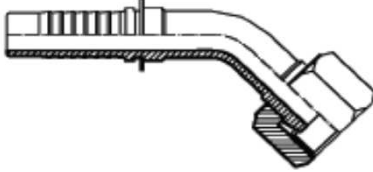

Krivina 90° O2 / Elbow 90° O2

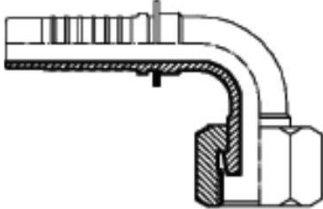

NP/DN	naziv/name	45°	90°	navoj/thread
6	Onp6	O1np6	O2np6	9/16"- unf
6	Onp6 11/16	O1np6 11/16	O2np6 11/16	11/16"- unf
8	Qnp8	Q1np8	Q2np8	11/16"- unf
10	Onp10	O1np10	O2np10	11/16"- unf
10	Onp10 13/16	O1np10 13/16	O2np10 13/16	13/16"- unf
12	Onp12	O1np12	O2np12	13/16"- unf
12	Onp12 1	O1np12 1	O2np12 1	1"- unf
12	Onp12 1.3/16	O1np12 1.3/16	O2np12 1.3/16	1.3/16"- unf
16	Onp16	O1np16	O2np16	1"- unf
16	Onp16 1.3/16	O1np16 1.3/16	O2np16 1.3/16	1.3/16"- unf
19	Onp19	O1np19	O2np19	1.3/16"- unf
19	Onp19 1.7/16	O1np19 1.7/16	O2np19 1.7/16	1.7/16"- unf
25	Onp25	O1np25	O2np25	1.7/16"- unf
32	Onp32	O1np32	O2np32	1.11/16"- unf
38	Onp38	O1np38	O2np38	2"- unf

Priklučak O (ORFS),ravno zaptivanje zenski priključak
Female flat face fitting (ORFS)

Priklučak OM (ORFS),ravno zaptivanje, muški priključak / Male flat face ORFS fitting

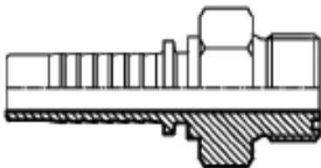

NP/DN	naziv/name	navoj/thread
6	OMnp6	9/16"- unf
6	OMnp6 11/16	11/16"- unf
8	QMnp8	11/16"- unf
10	OMnp10	11/16"- unf
10	OMnp10 13/16	13/16"- unf
12	OMnp12	13/16"- unf
12	OMnp12 1	1"- unf
12	OMnp12 1.3/16	1.3/16"- unf
16	OMnp16	1"- unf
16	OMnp16 1.3/16	1.3/16"- unf
19	OMnp19	1.3/16"- unf
19	OMnp19 1.7/16	1.7/16"- unf
25	OMnp25	1.7/16"- unf
32	OMnp32	1.11/16"- unf
38	OMnp38	2"- unf

Priklučci za visoki pritisak 1sn,2sn,4sp / High pressure hose fittings 1sn,2sn,4sp

Priklučak R5 (DKR-F) , ravno zaptivanje, ženski priključak, BSPP navoj
 "R5" (DKR-F), Flat face female fitting BSPP thread



NP/DN	naziv/name	navoj/thread
6	R5np6	G1/4"
8	R5np8	G3/8"
10	R5np10	G3/8"
10	R5np10 1/2	G1/2"
12	R5np12	G1/2"
12	R5np12 3/4	G3/4"
12	R5np12 1	G1"
16	R5np16	G5/8"
16	R5np16 3/4	G 3/4"
16	R5np16 1	G 1"
19	R5np19	G 3/4"
19	R5np19 1	G 1"
25	R5np25	G 1"
32	R5np32	G 1.1/4"

Priklučak F, ravno zaptivanje, muški priključak, BSPP navoj
 "F"-Flat face male fitting BSPP thread

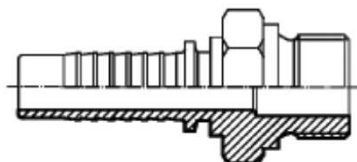

NP/DN	naziv/name	navoj/thread
6	F5np6	G1/4"
8	F5np8	G3/8"
10	F5np10	G3/8"
10	F5np10 1/2	G1/2"
12	F5np12	G1/2"
12	F5np12 3/4	G3/4"
12	F5np12 1	G1"
16	F5np16	G5/8"
16	F5np16 3/4	G 3/4"
16	F5np16 1	G 1"
19	F5np19	G 3/4"
19	F5np19 1	G 1"
25	F5np25	G 1"
32	F5np32	G 1.1/4"

Priklučak H (AGN 60° NPTF) muški priključak NPTF navoj
 "H"(AGN 60° NPTF) - male fitting NPTF thread



NP/DN	naziv/name	navoj/thread
6	Hnp6	1/4 nptf
8	Hnp8	3/8 nptf
10	Hnp10	3/8 nptf
12	Hnp12	1/2 nptf
16	Hnp16	1/2 nptf
19	Hnp19	3/4 nptf
25	Hnp25	1 nptf
32	Hnp32	1.1/4 nptf
38	Hnp38	1.1/2 nptf
50	Hnp50	2 nptf

Priklučci za visoki pritisak 1sn,2sn,4sp / High pressure hose fittings 1sn,2sn,4sp

Priključak H5 (AGR-K BSPT) muški priključak BSPT konusni navoj

"H5" (AGR-K BSPT) - male fitting BSPTthread



NP/DN	naziv/name	navoj/thread	
6	H5np6	1/4 bspt	
8	H5np8	3/8 bspt	
10	H5np10	3/8 bspt	
12	H5np12	1/2 bspt	
16	H5np16	1/2 bspt	
19	H5np19	3/4 bspt	
25	H5np25	1 bspt	
32	H5np32	1.1/4 bspt	
38	H5np38	1.1/2 bspt	
50	H5np50	2 bspt	

Priključak J (RNM) okasti / obrtni priključak

"J" (RNM) Banjo fitting

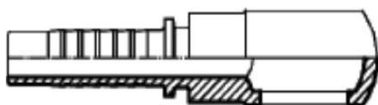

NP/DN	naziv/name	navoj/thread	navoj/thread
4	J np4	Ø10	G1/8
6	J np6	Ø12	
6	J np6Ø10	Ø10	G1/8
6	J np6Ø14	Ø14	
6	J np6Ø16	Ø16	
6	J np6Ø18	Ø18	
8	J np8	Ø14	G1/4
8	J np8Ø12	Ø12	
8	J np8Ø16	Ø16	
8	J np8Ø17	Ø17	G3/8
8	J np8Ø18	Ø18	
10	J np10	Ø16	
10	J np10Ø14	Ø14	
10	J np10Ø17	Ø17	G3/8
10	J np10Ø18	Ø18	
10	J np10Ø21	Ø21	G1/2
10	J np10Ø22	Ø22	
12	J np12	Ø18	
12	J np12Ø16	Ø16	
12	J np12Ø17	Ø17	G3/8
12	J np12Ø21	Ø21	G1/2
12	J np12Ø22	Ø22	
16	J np16	Ø22	
16	J np16Ø26	Ø26	
19	J np19	Ø26	
25	J np25	Ø30	

Priključci za visoki pritisak 1sn,2sn,4sp / High pressure hose fittings 1sn,2sn,4sp

Priključak "P" (3000 PSI) / Flange series 3000

Prav P / Straight P

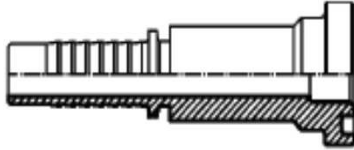

Krivina 45° P1/ Elbow 45° P1

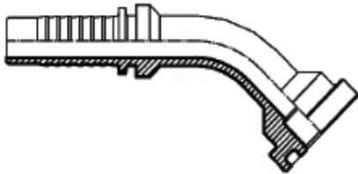

Krivina 90° P2/ Elbow 90° P2

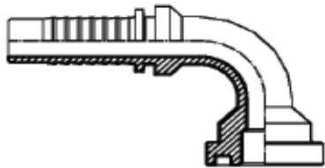

NP/DN	naziv/name	naziv/name	naziv/name	navoj/thread
12	Pnp12 30.2	P1np12 30.2	P2np12 30.2	30.20
12*	Pnp12 34	P1np12 34	P2np12 34	34.00
16*	Pnp16 34	P1np16 34	P2np16 34	34.00
19	Pnp19 38.1	P1np19 38.1	P2np19 38.1	38.10
19	Pnp19 44.5	P1np19 44.5	P2np19 44.5	44.50
25	Pnp25 44.5	P1np25 44.5	P2np25 44.5	44.50
25	Pnp25 50.8	P1np25 50.8	P2np25 50.8	50.80
32	Pnp32 50.8	P1np32 50.8	P2np32 50.8	50.80
38	Pnp38 60.3	P1np38 60.3	P2np32 60.3	60.30
50	Pnp50 71.4	P1np50 71.4	P2np50 71.4	71.40

*KOMATSU PRIRUBNICA / KOMATSU FLANGES

Priključak "P5" (6000 PSI) / Flange series 6000

Prav P5 / Straight P5

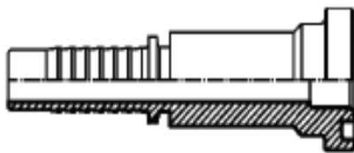

Krivina 45° P6 / Elbow 45° P6

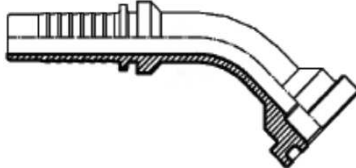

Krivina 90° P7/ Elbow 90° P7

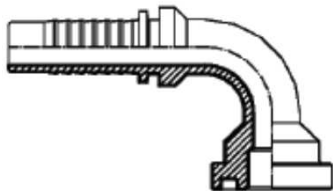

NP/DN	naziv/name	naziv/name	naziv/name	navoj/thread
12	P5np12 31.7	P6np12 31.7	P7np12 31.7	31.70
12	P5np12 41.3	P6np12 41.3	P7np12 41.3	41.30
16	P5np16 41.3	P6np16 41.3	P7np16 41.3	41.30
19	P5np19 41.3	P6np19 41.3	P7np19 41.3	41.30
19	P5np19 47.6	P6np19 47.6	P7np19 47.6	47.60
25	P5np25 47.6	P6np25 47.6	P7np25 47.6	47.60
25	P5np25 54	P6np25 54	P7np25 54	54.00
32	P5np32 54	P6np32 54	P7np32 54	54.00
32	P5np32 63.5	P6np32 63.5	P7np32 63.5	63.50
38	P5np38 63.5	P6np38 63.5	P7np38 63.5	63.50
50	P5np50 79.4	P6np50 79.4	P7np50 79.4	79.40

Priključci za visoki pritisak 1sn,2sn,4sp / High pressure hose fittings 1sn,2sn,4sp

Priključak PP, priključak pranje "Karcher" / Water jet cleaner fitting "Karcher" type

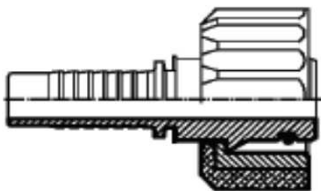

NP/DN	naziv/name	navoj/thread	
6	PPnp6	M22x1,5	
8	PPnp8	M22x1,5	
10	PPnp10	M22x1,5	

Priključak PU, priključak pranje "Karcher", uticni za pusku / Water jet cleaner fitting "Karcher" type-pistol



NP/DN	naziv/name	navoj/thread	
6	PUnp6	Ø 10	
8	PUnp8	Ø 10	
6	PUnp6	Ø 11	
8	PUnp8	Ø 11	

Gumeni stitnik za crevo / Rubber knobs washcleaner



NP/DN	naziv/name	navoj/thread	
6	GSnp6	Ø 16	
8	GSnp8	Ø 18	
10	GSnp10	Ø 21	
12	GSnp12	Ø 21	

Nastavak za crevo / Double connector



NP/DN	naziv/name	navoj/thread	
4	NA np4		
6	NA np6		
8	NA np8		
10	NA np10		
12	NA np12		
16	NA np16		
19	NA np19		
25	NA np25		
32	NA np32		
4/6	NA np4/6		
6/8	NA np6/8		
8/10	NA np8/10		
10/12	NA np10/12		
12/16	NA np12/16		
16/20	NA np16/19		

TABELA ZA IDENTIFIKACIJU NAVOJA / THREAD IDENTIFICATION

MILIMETARSKI MUŠKI NAVOJ 24°konus / METRIC THREAD 24° CONE MALE



Navoj / Thread	Cev /Tube	Milimetri
M10 X 1	5VL,6VL	10.00
M12X1,5	6L	12.00
M14X1,5	8L	14.00
M14X1,5	6T	14.00
M16X1,5	10L	16.00
M16X1,5	8T	16.00
M18X1,5	12L	18.00
M18X1,5	10T	18.00
M20X1,5	12T	20.00
M22X1,5	14T	22.00
M22X1,5	15L	22.00
M24X1,5	16T	24.00
M26X1,5	18L	26.00
M30X2	20T	30.00
M30X2	22L	30.00
M36X2	25T	36.00
M36X2	28L	36.00
M42X2	30T	42.00
M45X2	35L	45.00
M52X2	38T	52.00
M52X2	42L	52.00

MILIMETARSKI ŽENSKI NAVOJ 24°ZAPTIVANJE / METRIC THREAD 24°CONE FEMALE

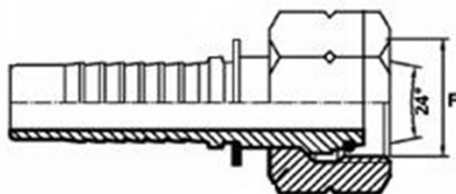

Navoj / Thread	Cev /Tube	Milimetri
M10 X 1	5VL,6VL	9.00
M12X1,5	6L	10.50
M14X1,5	8L	12.50
M14X1,5	6T	12.50
M16X1,5	10L	14.50
M16X1,5	8T	14.50
M18X1,5	12L	16.50
M18X1,5	10T	16.50
M20X1,5	12T	18.50
M22X1,5	14T	20.50
M22X1,5	15L	20.50
M24X1,5	16T	22.50
M26X1,5	18L	24.50
M30X2	20T	28.00
M30X2	22L	28.00
M36X2	25T	34.00
M36X2	28L	34.00
M42X2	30T	40.00
M45X2	35L	43.00
M52X2	38T	50.00
M52X2	42L	50.00

COLOVNI BSPP MUSKI NAVOJ 60°/ BSPP MALE 60° CONE



Navoj / Thread	Br.K.C/ n.Thr/Inc	mm
G 1/8	28	9.73
G 1/4	19	13.10
G 3/8	19	16.60
G 1/2	14	20.80
G 5/8	14	22.90
G 3/4	14	26.40
G 1	11	33.20
G 1.1/4	11	41.90
G 1.1/2	11	47.80
G 2	11	59.60

COLOVNI BSPP ŽENSKI NAVOJ 60°/ BSPP FEMALE 60° CONE



Navoj / Thread	Br.K.C/ n.Thr/Inc	mm
G 1/8	28	8.60
G 1/4	19	11.70
G 3/8	19	15.20
G 1/2	14	18.80
G 5/8	14	20.80
G 3/4	14	24.50
G 1	11	30.60
G 1.1/4	11	39.30
G 1.1/2	11	45.20
G 2	11	57.00

COLOVNI UNF MUŠKI NAVOJ 74°, JIC / MALE JIC 74° CONE UNF THREAD

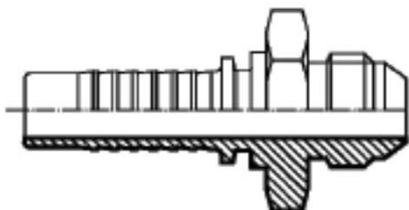

Navoj / Thread	Br.K.C/ n.Thr/Inc	mm
7/16 unf	20	11.10
1/2 unf	20	12.50
9/16 unf	18	14.20
3/4 unf	16	19.00
7/8 unf	14	22.20
1.1/16 unf	12	27.00
1.3/16 unf	12	30.10
1.5/16 unf	12	33.30
1.5/8 unf	12	41.20
1.7/8 unf	12	47.60

COLOVNI UNF ŽENSKI NAVOJ 74°, JIC / FEMALE JIC 74° CONE UNF THREAD



Navoj / Thread	Br.K.C/ n.Thr/Inc	mm
7/16 unf	20	9.90
1/2 unf	20	11.50
9/16 unf	18	12.90
3/4 unf	16	17.50
7/8 unf	14	20.50
1.1/16 unf	12	24.90
1.3/16 unf	12	28.10
1.5/16 unf	12	31.30
1.5/8 unf	12	38.80
1.7/8 unf	12	45.50
2.1/2 unf	12	61.4

ORFS MUŠKI NAVOJ RAVNO CELO, CAT. / ORFS MALE



Navoj / Thread	Br.K.C/ n.Thr/Inc	mm
9/16 unf	18	14.20
11/16 unf	16	17.50
13/16 unf	16	20.60
1 unf	14	25.40
1.3/16 unf	12	30.20
1.7/16 unf	12	36.50
1.11/16 unf	12	42.90

ORFS ŽENSKI NAVOJ RAVNO CELO, CAT. / ORFS FEMALE

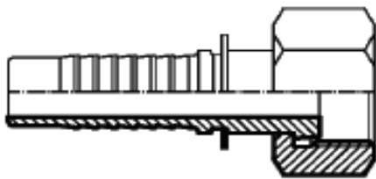

Navoj / Thread	Br.K.C/ n.Thr/Inc	mm
9/16 unf	18	13.00
11/16 unf	16	15.70
13/16 unf	16	18.90
1 unf	14	23.40
1.3/16 unf	12	27.90
1.7/16 unf	12	34.20
1.11/16 unf	12	40.60

BSPT MUŠKI NAVOJ KONUSNI / BSPT MALE



Navoj / Thread	Br.K.C/ n.Thr/Inc	mm
R1/4	19	13.60
R3/8	19	17.10
R1/2	14	20.80
R5/8	14	23.40
R3/4	14	27.00
R1	11	33.90
R1.1/4	11	42.60
R1.1/2	11	48.50

COLOVNI NPTF MUŠKI NAVOJ KONUSNI, AMERICKI / NPTF MALE



Navoj / Thread	Br.K.C/ n.Thr/Inc	mm
1/8 nptf	27	9.50
1/4 nptf	18	12.50
3/8 nptf	18	15.90
1/2 nptf	14	19.80
3/4 nptf	14	25.10
1 nptf	11	31.30
1.1/4 nptf	11	42.50
1.1/2 nptf	11	46.30